

# Lock Nut and Lock Washer Series AN, ANL, AW, AWL

www.exvalos.cz

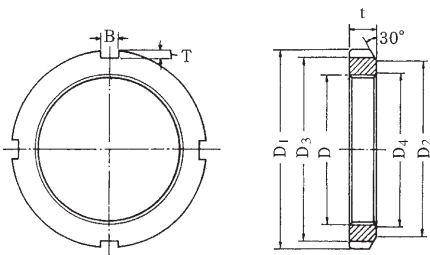

Series AN		Dimensions (mm)								ANL Series		Thread (Diameter, D x Pitch)		
Lock Nut Number	Lock Washer Number	AN series			AN/ANL			ANL Series			Lock Washer Number		Lock Nut Number	
		D <sub>1</sub>	D <sub>2</sub>	D <sub>3</sub>	t	B	T	D <sub>4</sub>	D <sub>1</sub>	D <sub>2</sub>				D <sub>3</sub>
AN 00	AW 00	18	13	14	4	3	2	10.5	-	-	-	-	-	M 10X0.75
01	01	22	17	18	4	3	2	12.5	-	-	-	-	-	12X1
02	02	25	21	21	5	4	2	15.5	-	-	-	-	-	15X1
AN 03	AW 03	28	24	24	5	4	2	17.5	-	-	-	-	-	M 17X1
04	04	32	26	28	6	4	2	20.5	-	-	-	-	-	20X1
05	05	38	32	34	7	5	2	25.8	-	-	-	-	-	25X1.5
AN 06	AW 06	45	38	41	7	5	2	30.8	-	-	-	-	-	M 30X1.5
07	07	52	44	48	8	5	2	35.8	-	-	-	-	-	35X1.5
08	08	58	50	53	9	6	2.5	40.8	-	-	-	-	-	40X1.5
AN 09	AW 09	65	56	60	10	6	2.5	45.8	-	-	-	-	-	M 45X1.5
10	10	70	61	65	11	6	2.5	50.8	-	-	-	-	-	50X1.5
11	11	75	67	69	11	7	3	56	-	-	-	-	-	55X2
AN 12	AW 12	80	73	74	11	7	3	61	-	-	-	-	-	M 60X2
13	13	85	79	79	12	7	3	66	-	-	-	-	-	65X2
14	14	92	85	85	12	8	3.5	71	-	-	-	-	-	70X2
AN 15	AW 15	98	90	91	13	8	3.5	76	-	-	-	-	-	M 75X2
16	16	105	95	98	15	8	3.5	81	-	-	-	-	-	80X2
17	17	110	102	103	16	8	3.5	86	-	-	-	-	-	85X2
AN 18	AW 18	120	108	112	16	10	4	91	-	-	-	-	-	M 90X2
19	19	125	113	117	17	10	4	96	-	-	-	-	-	95X2
20	20	130	120	122	18	10	4	101	-	-	-	-	-	100X2
AN 21	AW 21	140	126	130	18	12	5	106	-	-	-	-	-	M 105X2
22	22	145	133	135	19	12	5	111	-	-	-	-	-	110X2
23	23	150	137	140	19	12	5	116	-	-	-	-	-	115X2
AN 24	AW 24	155	138	145	20	12	5	121	145	133	135	AWL 24	ANL 24	M 120X2
25	25	160	148	150	21	12	5	126	-	-	-	-	-	125X2
26	26	165	149	155	21	12	5	131	155	143	145	AWL 26	ANL 26	130X2
AN 27	AW 27	175	160	163	22	14	6	136	-	-	-	-	-	M 135X2
28	28	180	160	168	22	14	6	141	165	151	153	AWL 28	ANL 28	140X2
29	29	190	171	178	24	14	6	146	-	-	-	-	-	145X2
AN 30	AW 30	195	171	183	24	14	6	151	180	164	168	AWL 30	ANL 30	M 150X2
31	31	200	182	186	25	16	7	156.5	-	-	-	-	-	155X3
32	32	210	182	196	25	16	7	161.5	190	174	176	AWL 32	ANL 32	160X3
AN 33	AW 33	210	193	196	26	16	7	166.5	-	-	-	-	-	M 165X3
34	34	220	193	206	26	16	7	171.5	200	184	186	AWL 34	ANL 34	170X3
36	36	230	203	214	27	18	8	181.5	210	192	194	36	36	180X3
AN 38	AW 38	240	214	224	28	18	8	191.5	220	202	204	AWL 38	ANL 38	M 190X3
40	40	250	226	234	29	18	8	201.5	240	218	224	40	40	200X3

\* ANL Nut for H30 Adapter

Lock Nut / Lock Washer

# Lock Nut Series AN, ANL

www.exvalos.cz

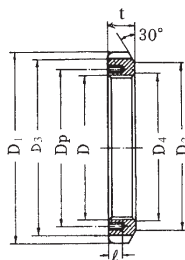
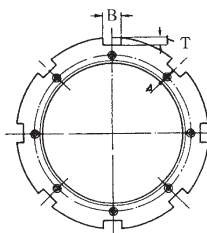

Lock Nut / Lock Washer

Lock Nut Number	Dimensions (mm)										PLATE HOLE		
	Thread (Diameter, D x Pitch)	D <sub>1</sub>	D <sub>2</sub>	D <sub>3</sub>	B	T	D <sub>4</sub>	t	Thread (Diameter, D x Pitch)	l	D <sub>1</sub>		
AN 44	Tr 220X4	280	250	260	20	10	222	32	M 8X1.25	15	238		
48	240X4	300	270	280	20	10	242	34	8X1.25	15	258		
52	260X4	330	300	306	24	12	262	36	10X1.5	18	281		
AN 56	Tr 280X4	350	320	326	24	12	282	38	M 10X1.5	18	301		
60	300X4	380	340	356	24	12	302	40	10X1.5	18	326		
64	320X5	400	360	376	24	12	322.5	42	10X1.5	18	345		
AN 68	Tr 340X5	440	400	410	28	15	342.5	55	M 12X1.75	21	372		
72	360X5	460	420	430	28	15	362.5	58	12X1.75	21	392		
76	380X5	490	450	454	32	18	382.5	60	12X1.75	21	414		
AN 80	Tr 400X5	520	470	484	32	18	402.5	62	M 16X2	27	439		
84	420X5	540	490	504	32	18	422.5	70	16X2	27	459		
88	440X5	560	510	520	36	20	442.5	70	16X2	27	477		

## Nut-Series ANL \*

ANL 44	Tr 220X4	260	242	242	20	9	222	30	M 6X1	12	229
48	240X4	290	270	270	20	10	242	34	8X1.25	15	253
52	260X4	310	290	290	20	10	262	34	8X1.25	15	273
ANL 56	Tr 280X4	330	310	310	24	10	282	38	M 8X1.25	15	293
60	300X4	360	336	336	24	12	302	42	8X1.25	15	316
64	320X5	380	356	356	24	12	322.5	42	8X1.25	15	335
ANL 68	Tr 340X5	400	376	376	24	12	342.5	45	M 8X1.25	15	355
72	360X5	420	394	394	28	13	362.5	45	8X1.25	15	374
76	380X5	450	422	422	28	14	382.5	48	10X1.5	18	398
ANL 80	Tr 400X5	470	442	442	28	14	402.5	52	M 10X1.5	18	418
84	420X5	490	462	462	32	14	422.5	52	10X1.5	18	438
88	440X5	520	490	490	32	15	442.5	60	12X1.75	21	462
ANL 92	Tr 460X5	540	510	510	32	15	462.5	60	M 12X1.75	21	482
96	480X5	560	530	530	36	15	482.5	60	12X1.75	21	502

\* ANL Nut for H30 Adapter